

30 - 150 TON ALUMINUM

CYLINDERS

Simplex Silver Lite Aluminum Cylinders Cut Carrying Weights Up To 60%.

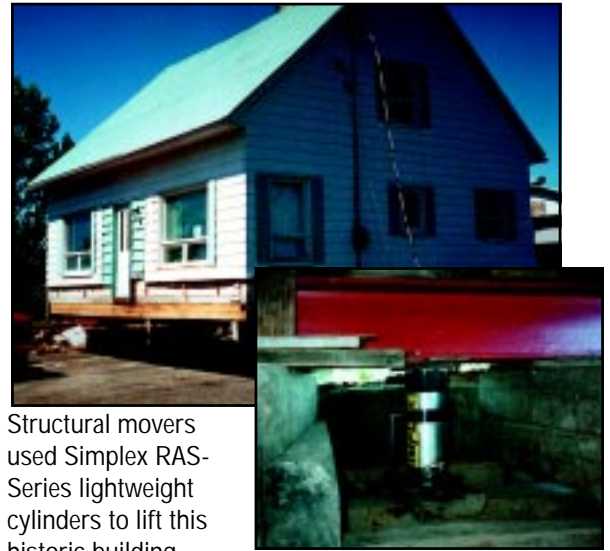

Structural movers used Simplex RAS-Series lightweight cylinders to lift this historic building.

"Simplex lightweight cylinders were easy to carry and position and the 203mm stroke reduced cribbing time."

- 13 Standard Models from 30 through 150 tons.
- Up to 60% lighter than steel cylinders.
- High flow quality couplers.
- Large bearing surfaces for side load protection.
- Hard anodized housing & piston reduce wear & corrosion.
- Heavy duty spring for fast & full retraction.
- Rod wiper protects inner cylinder from dirt.
- Complies with ANSI/ASME B30.1 safety standards.

		
Power Pumps pgs. 40-58	Hoses pgs. 66-67	Accessories & Fittings pg. 62-68

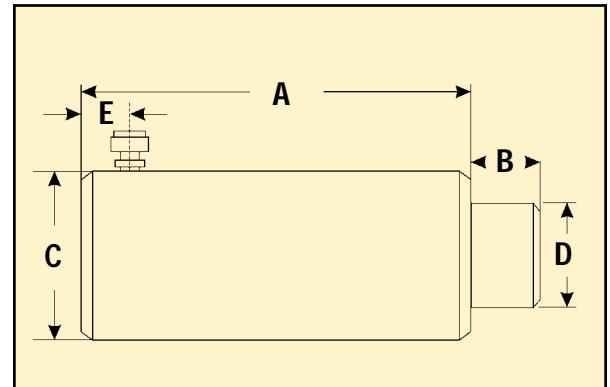

Aluminum Spring Return Cylinders 30 Through 150 Ton Capacities

Model Number	Cap. (tons)	Stroke (mm)	A Min. Ht. (mm)	B Ext. Ht. (mm)	Effect Area (cm ²)	Oil Cap. Req'd (cm ³)	C Body O.D. (mm)	D Piston O.D. (mm)	E Base To Port C/L (mm)	Weight (Kg)	Sugstd. Hand Pump
RAS302B	30	50	165	215	41.9	213	101	64	38	6,4	P42
RAS306B		152	267	419		639				8,2	P82
RAS502B	50	50	165	215	71.2	360	133	79	38	5,9	P82
RAS504B		100	216	316		723				7,7	P82
RAS506B		152	267	419		1085				12,7	P140
RAS5010B		254	368	622		1809				16,4	*
RAS1002B		50	165	215		675				18,2	P82
RAS1004B	100	100	216	316	133	1351	190	108	38	20,5	P140
RAS1006B		152	267	419		2027				22,7	*
RAS10010B		254	368	622		3379				30,9	*
RAS1502B		50	165	215		1005				26,4	P140
RAS1506B	150	152	267	419	198	3016	254	127	38	39,1	*
RAS15010B		254	368	622		5027				50	*

*Power pumps are suggested for these units (see pages 40 - 58).

CUSTOM STROKES AND CAPACITIES AVAILABLE CONTACT FACTORY