

CYLINDERS

2 - 5 TON PULL CYLINDERS

Simplex Pull Cylinders Are Designed For Pulling & Tensioning Applications.

The RP25 & RP55 have rod, base and collar threads for maximum flexibility in fixturing using optional attachments.



- 2 Models.
- High flow couplers.
- Designed for pulling & tensioning applications.
- High strength all steel construction.
- Chrome plated piston rods resist corrosion.
- Rod wiper protects against contamination.
- Piston rod automatically extends when pressure is released.
- High strength compression spring provides long cycle life and quick piston extension.
- Complies with ANSI/ASME B30.1 safety standards.

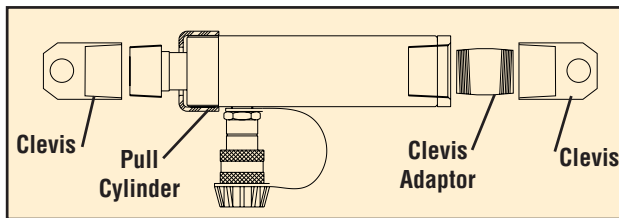

Base Clevis Adaptor

Clevis

Clevis Ends

Model Number	A (in)	B (in)	C (in)	D (in)	E (in)	F (in)
RPC25	5 1/8	4 5/16	1 5/16	2	3/4	1
RPC55	6	5	1 1/2	2 1/2	7/8	1 1/2

Both models include both adaptor and clevis.

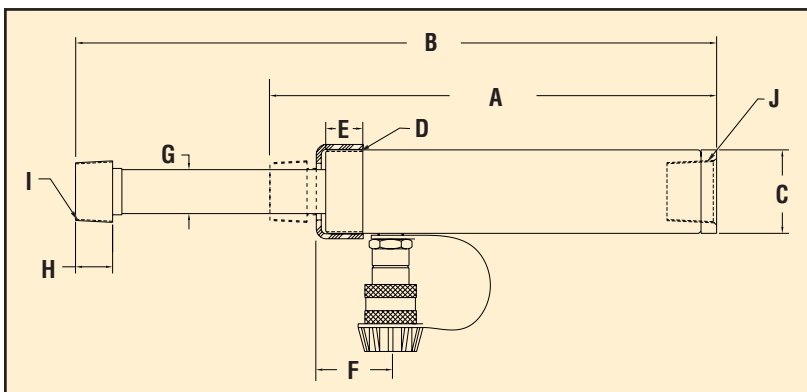

Hydraulic Pull Cylinders

Model Number	Cap. (tons)	Stroke (in)	A Min. Ht. (in)	B Ext. Ht. (in)	C O.D. (in)	D Collar Thrd. (in)	E Collar Length (in)	F Cyl. to Port (in)	G Piston Dia. (in)	H Piston Adpt. (in)	I NPTF Thrd. (in)	J NPTF Thrd. (in)	Oil Cap. (cu. in.)	Pres. @ Cap. (psi)	Wgt. (lbs)
RP25	2	5	9 9/16	14 9/16	1 3/4	1 1/2-16	1	1 11/16	3/4	1	3/4-14	3/4-14	2.8	7,250	4
RP55	5	5 1/2	11 7/8	17 3/8	2 1/4	2 1/4-14	1	1 11/16	1 3/16	1 3/8	1 1/4-11 1/2	1 1/4-11 1/2	6.2	8,850	11

P42 is the suggested hand pump.